

# CHR250-12

12V 250AH

High Rate Battery



## CHR250-12



## Physical Specification

Part Number:	CHR250-12
Length:	522±1mm (20.55 inches)
Width:	268±1mm (10.55 inches)
Container Height:	220±1mm (8.66 inches)
Total Height (with terminal):	226±1mm (8.90 inches)
Approx Weight:	73.3 Kg (161.6 lbs)

## Specifications

	Nominal Voltage	12V	
	Nominal Rate (W ,1.67V/cell)	820W	
	Nominal Capacity (C10,1.80V/cell)	250Ah	
	Technology	High Rate Discharge	
	Terminal Type	M8	
Container Material	Flame Retardant (FR)	ABS (UL94:VO)	
Rated Capacity (25°C)	(10hr, 25.0A,1.80V/cell)	250.0 Ah	
	(8hr, 30.0A,1.80V/cell)	240.0 Ah	
	(5hr, 43.8A,1.75V/cell)	219.0 Ah	
	(3hr, 66.3A,1.75V/cell)	198.9 Ah	
	(1hr, 160.0A,1.67V/cell)	160.0 Ah	
Max Currents (5s)	2500A		
Internal Resistance	Approx. 2.5mΩ		
Discharge Characteristics	Operating Temp. Range	Discharge: -20°C~55°C (-4°F~131°F)	
		Charge: 0°C~40°C (32°F~104°F)	
		Storage: -15°C~50°C (5°F~122°F)	
Nominal Operating Temp. Range	Nominal Operating Temp. Range	25 ± 3°C (77 ± 5°F)	
	Max.Charging Current(25 C)	62.5A	
	Charge voltage(25 C)	Float	13.5V
		Temp. Coefficient	-3m V/cell/ C
		Equalization	14 .1~14.4V
	Effect of temperature on Capacity	40°C (104°F)	106%
		25°C (77°F)	100%
0°C (32°F)		86%	
Design Floating Life at 20°C	20+ Years		
Self Discharge	Canbat High Rate batteries may be stored for up to 6 months at 25°C (77°F) and then a refresh charge is required. For higher temperatures the time interval will be shorter. Self-discharge is less than 2%		

## Dimensions

### M8 Terminal

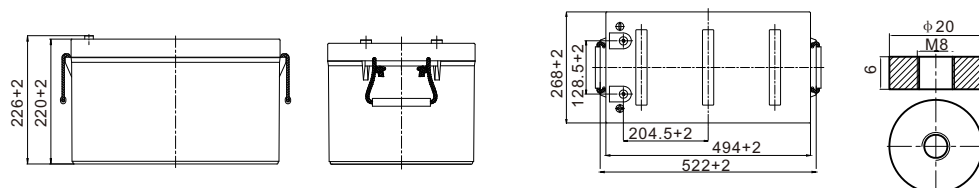

To ensure safe and efficient operation always refer to the latest edition of our datasheets, as published on our website [www.canbat.com](http://www.canbat.com). Canbat Technologies Inc. All rights reserved. All trademarks are the property of their respective owners. All data subject to change without notice. E&O.E

# CBL250-12

12V 250AH

High Rate Battery



## Constant Current Discharge (Amperes) at 25 °C (77°F)

F.V/Time	5min	10min	15min	20min	30min	45min	1h	1.5h	2h	3h	4h	5h	8h	10h
1.85V/cell	520.3	388.4	323.5	271.9	209.0	155.9	131.7	98.8	79.1	59.6	47.5	39.7	28.0	23.4
1.80V/cell	606.5	458.0	376.2	313.3	236.2	174.4	145.8	108.1	86.0	64.5	51.2	42.8	30.0	25.0
1.75V/cell	661.9	491.1	397.9	328.7	246.9	181.4	151.2	111.7	88.7	66.3	52.5	43.8	30.5	25.4
1.70V/cell	716.8	523.8	420.6	345.9	257.8	188.3	156.7	115.5	91.5	68.2	53.8	44.7	31.1	25.8
1.67V/cell	748.4	543.0	433.8	355.7	264.3	192.6	160.0	117.6	93.0	69.2	54.6	45.3	31.4	26.0
1.60V/cell	825.0	587.5	465.0	378.8	279.3	202.5	167.8	122.8	96.9	71.8	56.4	46.7	32.2	26.6

## Constant Power Discharge (Watts/cell) at 25 °C (77°F)

F.V/Time	5min	10min	15min	20min	30min	45min	1h	1.5h	2h	3h	4h	5h	8h	10h
1.85V/cell	983.7	732.1	642.7	615.4	475.3	349.0	264.0	198.6	158.3	119.9	98.8	84.3	59.8	50.0
1.80V/cell	1111.7	800.6	690.1	653.8	498.6	364.7	278.2	207.1	166.3	124.8	102.6	87.2	61.1	51.2
1.75V/cell	1198.2	865.3	737.6	684.9	524.4	384.8	294.1	218.5	173.1	129.5	106.0	89.9	62.1	51.6
1.70V/cell	1273.5	925.4	777.6	716.5	551.6	401.0	304.2	225.5	178.7	132.7	108.4	91.4	62.8	52.0
1.67V/cell	1320.2	980.9	820.0	745.1	570.9	412.3	313.4	232.0	183.4	136.2	110.3	92.6	63.4	52.4
1.60V/cell	1339.1	1033.4	849.3	767.6	585.7	421.4	320.5	236.6	186.8	137.4	111.4	94.0	64.1	53.1

### Discharge Characteristics

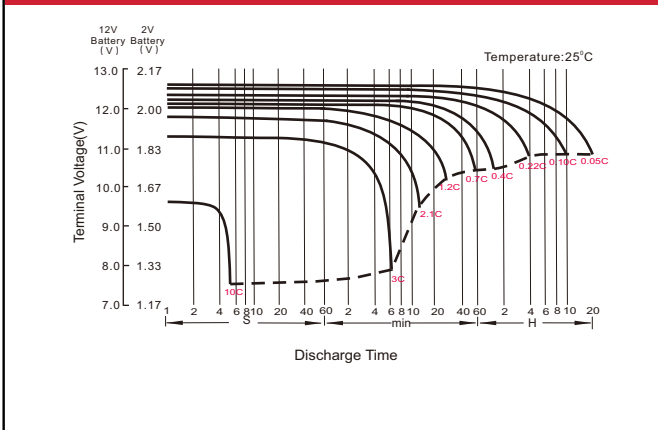

### Float Charging Characteristics

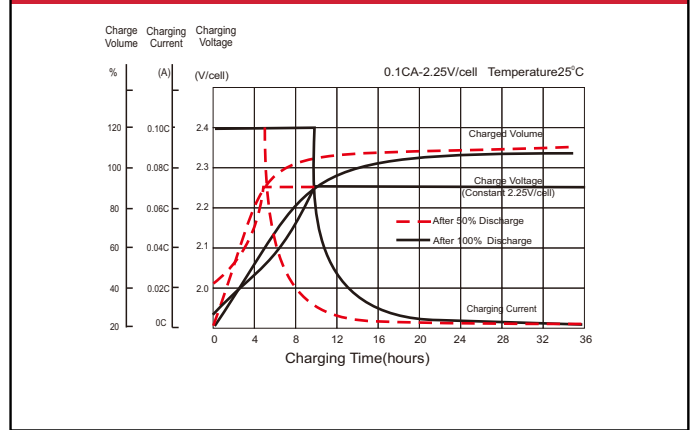

### Temperature Effects in Relation to Battery Capacity

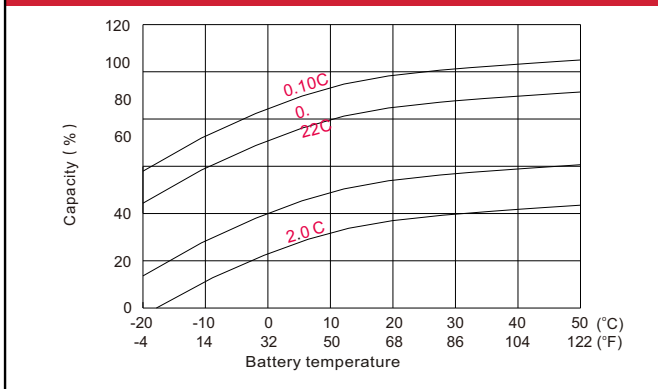

### Temperature Effects on Long Term Float Life

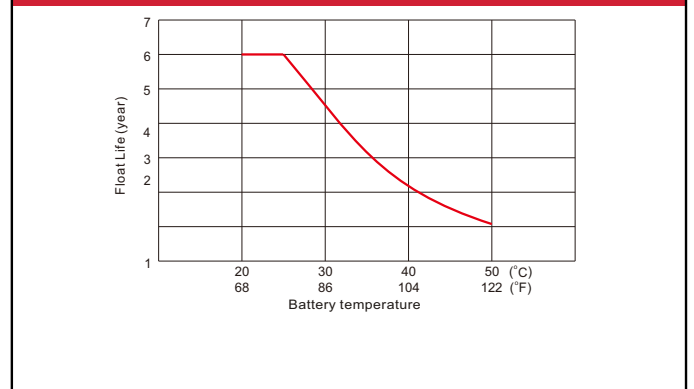

### High Rate Batteries

The most important asset for many businesses is data. Whether it's customer data, employee data or financial data, no business can afford to lose it. Unfortunately, unexpected power interruptions may lead to a loss of data, which could potentially cost thousands of dollars. To solve this issue, Canbat has developed the highest performing high rate batteries, which are specially designed for back-up power systems. Our batteries have a proven track record to be the most reliable in the industry, backed up with the best warranty in Canada. In the event of a power outage, UPS systems provide back-up power to your equipment. The most important component in any UPS is the battery. Whether the UPS is hooked up to your personal computer at home, or to your equipment at work, Canbat offers top-performing batteries you can count on. If you don't have high performing batteries in your UPS during a power outage, you are putting yourself at risk of losing data. A power surge or blackout could erase hours of hard work and damage your equipment.

To ensure safe and efficient operation always refer to the latest edition of our datasheets, as published on our website [www.canbat.com](http://www.canbat.com). Canbat Technologies Inc. All rights reserved. All trademarks are the property of their respective owners. All data subject to change without notice. E&O.E