



Model : GC2-30-48 | Voltage: 51.2V | Capacity: 30Ah | Energy: 1536Wh | Group: GC2

## ELECTRICAL SPECIFICATIONS

Nominal Voltage	51.2V
Nominal Capacity	30Ah
Capacity @ 30A	60 min
Resistance	≤ 50mΩ @1kHz AC
Efficiency	96%
Self Discharge	≤3% per Month
Maximum Modules in Parrallel	10 Batteries (300Ah)

## DISCHARGE SPECIFICATIONS

Maximum Continuous Discharge Current	30A/60min
Peak Discharge Current	100A/10s
Recommended Low Voltage Disconnect	52V
BMS Discharge Voltage Cut-Off	45V
Reconnect Voltage	48V
Short Circuit Protection	500A/400uS

## TEMPERATURE SPECIFICATIONS

Discharge Temperature	-20~60°C
Charge Temperature	0~60°C
Storage Temperature ≤ 1 month	-20~60°C
Storage Temperature ≤ 3 months	-10~45°C
Recommended Storage Temperature	15~35°C

## MECHANICAL SPECIFICATIONS

Dimensions (L x W x H)	260 x 180 x 283 mm 10.2 x 7.08 x 11.14 inch
Weight	33 lbs (15 kg)
Terminal Type	M8 x 1.25 x 12mm
Terminal Torque	80 - 100 in-lbs (8 - 12 N-m)
Case Material	ABS+PC/UL94-V0
Enclosure Protection	IP67
Cell Type - Chemistry	Prismatic - LiFePO4

## CHARGING CHARACTERISTICS

Recommended Charge Current	≤ 15A
Maximum Charge Current	30A
Recommended Charge Voltage	57.6 V
BMS Charge Voltage Cut-Off	59.2 V

## DIMENSIONAL SPECIFICATIONS

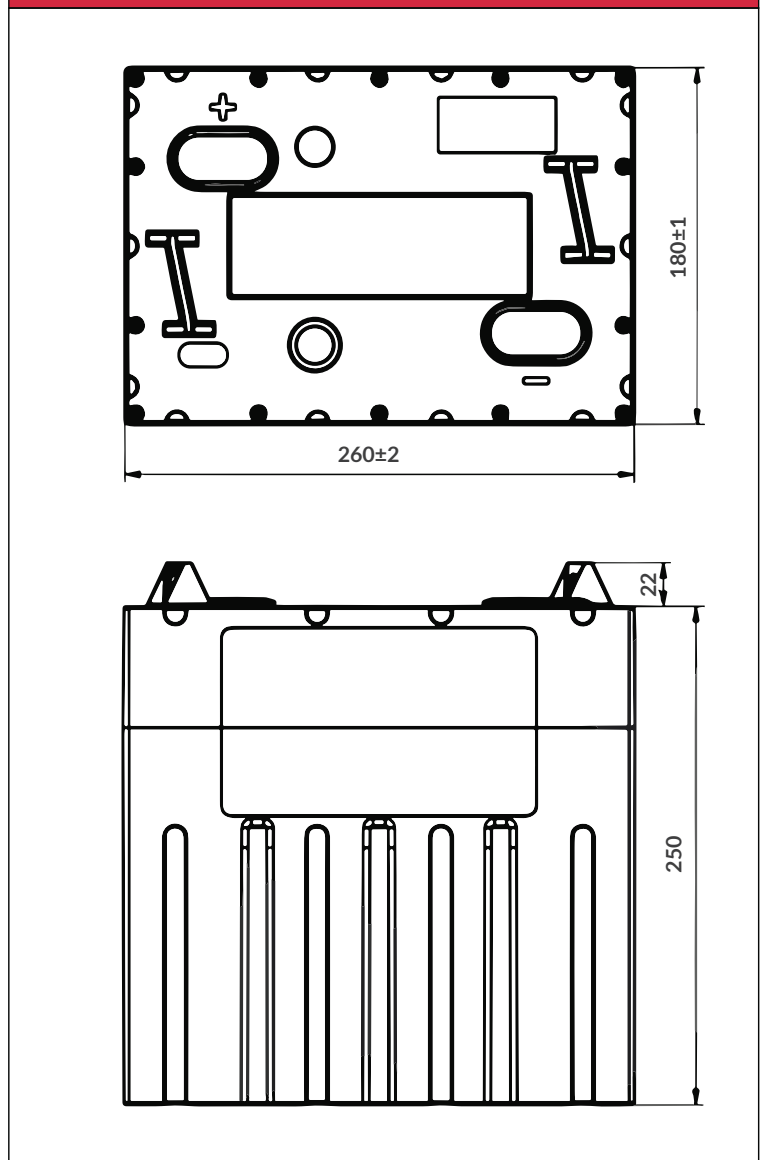

To ensure safe and efficient operation always refer to the latest edition of our datasheets, as published on our website [www.canbat.com](http://www.canbat.com). Canbat Technologies Inc. All rights reserved. All trademarks are the property of their respective owners. All data subject to change without notice. E&O.E