

# CFT125-12

12V 125AH

Front Terminal Battery



## CFT125-12



## Physical Specification

Part Number:	<b>CFT125-12</b>
Length:	<b>551 ± 2 mm ( 21.7 inches)</b>
Width:	<b>110 ± 2 mm ( 4.33 inches)</b>
Container Height:	<b>288 ± 2 mm ( 11.3 inches)</b>
Total Height (with terminal):	<b>288 ± 2 mm ( 11.3 inches)</b>
Approx Weight:	<b>41.5 Kg (91.5 lbs)</b>

## Specifications

	Nominal Voltage	12V
	(C10, 1.80V/cell)	125AH
<b>Terminal Option</b>	M6	
<b>Container Material</b>	Standard Option	ABS
	Flame Retardant Option (FR)	ABS (UL94:VO)
<b>Rated Capacity</b>	(20hr, 6.56A, 1.80V/cell)	131.2 Ah
	(10hr, 12.5A, 1.80V/cell)	125.0 Ah
	(8hr, 15.3A, 1.75V/cell)	122.4 Ah
	(5hr, 21.9A, 1.75V/cell)	109.5 Ah
	(1hr, 80.0A, 1.67V/cell)	80.0 Ah
<b>Max Discharge Current (5s)</b>	1250A	
<b>Internal Resistance</b>	Approx. 4.3 mΩ	
<b>Discharge Characteristics</b>	Operating Temp. Range	Discharge: -15°C~50°C (5°F~122°F)
		Charge: 0°C~40°C (32°F~104°F)
		Storage: -15°C~40°C (5°F~104°F)
	Nominal Operating Temp. Range	25 ± 3°C (77 ± 5°F)
	Cycle Use	Initial Charging Current less than 37.5A. Voltage 14.1V~14.4V at 25°C (77°F) Temp. Coefficient -30mV/°C
	Standby Use	Initial Charging Current less than 37.5A. Voltage 13.5V~13.8V at 25°C (77°F) Temp. Coefficient -20mV/°C
	Capacity affected by Temperature	40°C (104°F)
25°C (77°F)		100%
0°C (32°F)		86%
<b>Design Floating Life at 20°C</b>	12+ Years	
<b>Self Discharge</b>	Canbat Front Terminal batteries may be stored for up to 6 months at 25°C (77°F) and then a refresh charge is required. For higher temperatures the time interval will be shorter. Self-discharge is less than 2%	

## Dimensions

### M6 Terminal

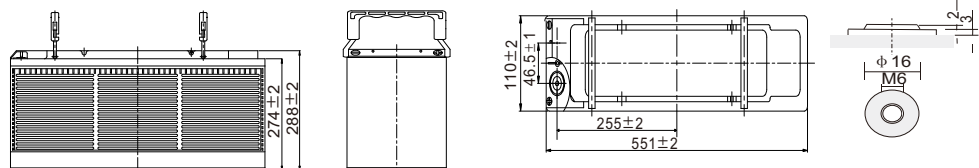

To ensure safe and efficient operation always refer to the latest edition of our datasheets, as published on our website [www.canbat.com](http://www.canbat.com). Canbat Technologies Inc. All rights reserved. All trademarks are the property of their respective owners. All data subject to change without notice. E&O.E

### Constant Current Discharge (Amperes) at 25 °C (77°F)

F.V/Time	10min	15min	20min	30min	45min	1h	2h	3h	4h	5h	6h	8h	10h	20h
1.85V/cell	180.8	161.8	141.6	114.6	88.4	65.9	39.5	29.8	23.8	19.9	18.1	14.0	11.7	6.15
1.80V/cell	210.0	188.1	157.2	123.9	93.3	72.9	43.0	32.3	25.6	21.4	18.5	15.0	12.5	6.56
1.75V/cell	231.8	199.0	167.7	129.6	96.7	75.6	44.3	33.1	26.3	21.9	18.8	15.3	12.7	6.66
1.70V/cell	246.8	210.3	174.0	133.4	98.7	78.4	45.8	34.1	26.9	22.4	19.1	15.5	12.9	6.77
1.67V/cell	258.0	216.9	178.8	136.0	100.8	80.0	46.5	34.6	27.3	22.7	19.3	15.7	13.0	6.83
1.60V/cell	269.3	232.5	183.0	139.6	102.4	83.9	48.5	35.9	28.2	23.3	19.4	16.1	13.3	6.97

### Constant Power Discharge (Watts/cell) at 25 °C (77°F)

F.V/Time	10min	15min	20min	30min	45min	1h	2h	3h	4h	5h	6h	8h	10h	20h
1.85V/cell	337.5	310.8	269.7	220.6	171.7	128.0	77.3	58.5	46.7	39.1	35.9	27.7	23.2	12.5
1.80V/cell	387.6	357.6	295.1	235.0	179.9	140.7	83.6	63.0	50.2	42.0	36.7	29.6	24.7	13.2
1.75V/cell	420.9	374.3	311.8	243.8	184.5	144.9	85.7	64.4	51.2	42.8	37.1	30.1	25.0	13.3
1.70V/cell	438.1	391.2	321.2	249.6	187.7	149.2	88.0	66.0	52.3	43.6	37.5	30.5	25.4	13.5
1.67V/cell	456.3	404.6	328.7	253.9	191.2	151.6	89.2	66.8	52.9	44.1	37.8	30.8	25.6	13.6
1.60V/cell	463.1	422.1	331.6	254.9	192.0	157.5	92.2	68.8	54.4	45.2	38.0	31.4	26.1	13.8

### Discharge Characteristics

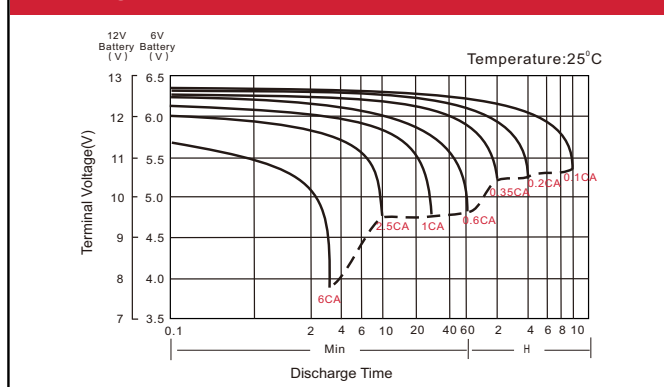

### Float Charging Characteristics

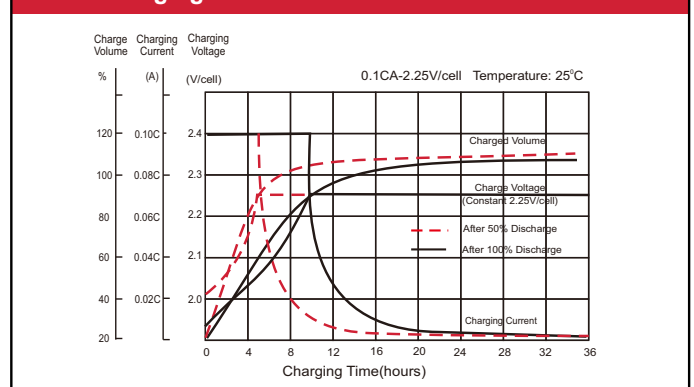

### Temperature Effects in Relation to Battery Capacity

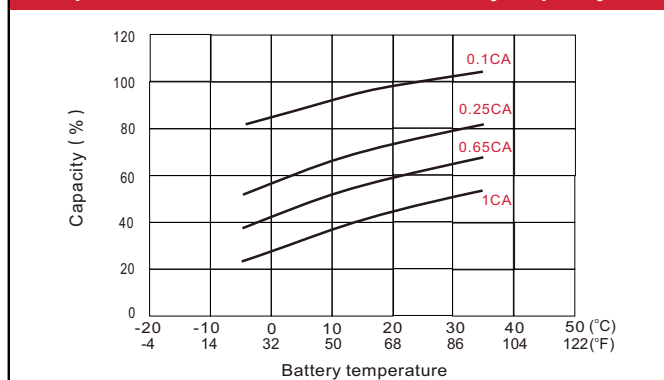

### Float Service Life

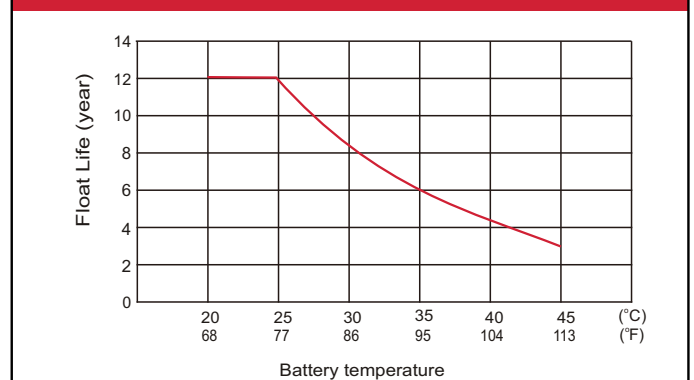

### Front Terminal Battery Features

- Front terminal design
- Absorbent Glass Mat (AGM)
- Short recharging time
- Spill-free / Spill-proof
- High power and volume ratio
- High reliability
- Oxygen recombination technology
- Unrivalled energy density
- Rechargeable lead acid battery
- Alloy plate grid
- Valve regulated
- Optimum quality
- Low self-discharge rate
- Extremely safe operations
- Developed in Canada